

PET Maschinen · P.E.T. Machines

Machines PET · Macchine PET · Máquinas de PET

**D****Lange Lebensdauer**

Kolben: gehärtet, Titanaluminiumnitrid beschichtet

Integrierter Festanschlag

Spezialdichtungen + Öle

Temperatur

-30°C - +100°C

RoHS konform

Richtlinie 2002/95/EG

GB**Extended life time**Piston: hardened,
Titanium aluminium nitride

Integrated end stop

Special Seals + Oils

Temperature

-30°C - +100°C

RoHS compliant

Directive 2002/95/EC

F**Longévité**

Piston: trempé,

Nitrure de titane aluminium

Butée de fin de course intégrée

Joints et huiles spécifiques

Températures

-30°C - +100°C

RoHS compliantes

Directive 2002/95/EC

I**Lunga durata**Pistone: temprato,
Nitruro di titanio e alluminio

Battuta integrata

Guarnizioni + olio speciale

Temperatura

-30°C - +100°C

RoHS compliant

Direttiva 2002/95/EC

E**Larga vida útil**

Émbolo: templado,

Nitruro de titanio aluminio

Tope fijo integrado: máxima seguridad

Juntas especiales + aceites

Temperaturas

-30°C - +100°C

RoHS y que cumplan

Directiva 2002/95/CE

Архангельск (8182)63-90-72
 Астана (7172)727-132
 Астрахань (8512)99-46-04
 Барнаул (3852)73-04-60
 Белгород (4722)40-23-64
 Брянск (4832)59-03-52
 Владивосток (423)249-28-31
 Волгоград (844)278-03-48
 Вологда (8172)26-41-59
 Воронеж (473)204-51-73
 Екатеринбург (343)384-55-89
 Иваново (4932)77-34-06

Ижевск (3412)26-03-58
 Иркутск (395)279-98-46
 Казань (843)206-01-48
 Калининград (4012)72-03-81
 Калуга (4842)92-23-67
 Кемерово (3842)65-04-62
 Киров (8332)68-02-04
 Краснодар (861)203-40-90
 Красноярск (391)204-63-61
 Курск (4712)77-13-04
 Липецк (4742)52-20-81
 Киргизия (996)312-96-26-47

Магнитогорск (3519)55-03-13
 Москва (495)268-04-70
 Мурманск (8152)59-64-93
 Набережные Челны (8552)20-53-41
 Нижний Новгород (831)429-08-12
 Новокузнецк (3843)20-46-81
 Новосибирск (383)227-86-73
 Омск (3812)21-46-40
 Орел (4862)44-53-42
 Оренбург (3532)37-68-04
 Пенза (8412)22-31-16
 Россия (495)268-04-70

Пермь (342)205-81-47
 Ростов-на-Дону (863)308-18-15
 Рязань (4912)46-61-64
 Самара (846)206-03-16
 Санкт-Петербург (812)309-46-40
 Саратов (845)249-38-78
 Севастополь (8692)22-31-93
 Симферополь (3652)67-13-56
 Смоленск (4812)29-41-54
 Сочи (862)225-72-31
 Ставрополь (8652)20-65-13
 Казахстан (772)734-952-31

Сургут (3462)77-98-35
 Тверь (4822)63-31-35
 Томск (3822)98-41-53
 Тула (4872)74-02-29
 Тюмень (3452)66-21-18
 Ульяновск (8422)24-23-59
 Уфа (347)229-48-12
 Хабаровск (4212)92-98-04
 Челябинск (351)202-03-61
 Череповец (8202)49-02-64
 Ярославль (4852)69-52-93

Gehärteter aluminium-titan beschichteter Kolben für lange Lebensdauer

- Hardened aluminium-titanium coated piston for a long service life
- Piston trempé revêtu d'aluminium et de titane pour une meilleure durée de vie
- Pistone rivestito di alluminio-titanio temprato per una lunga durata
- Émbolos templados revestidos de aluminio-titano para una mayor vida útil.

Integrierter Festanschlag

- Integrated end-stop
- Butée de fin de course intégrée
- Battuta di fine corsa integrata
- Tope fijo integrado

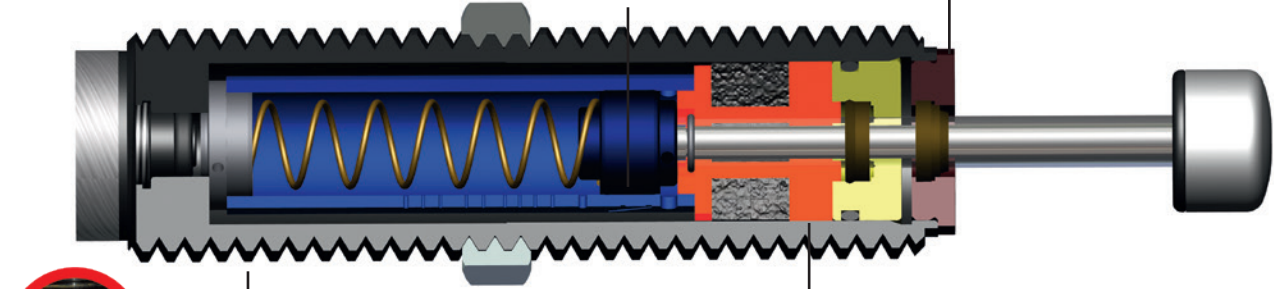

Pro-Surf

- für hohe Korrosionsbeständigkeit
- for high corrosion resistance
- pour une meilleure résistance à la corrosion
- per un'elevata resistenza anticorrosione
- para una mayor resistencia a la corrosión

Hochtemperatur Dichtungspaket

- High temperature seals
- Joints haute température
- Guarnizioni per temperature elevate
- Juntas resistentes a temperaturas elevadas

Weforma PET-Stoßdämpfer wurden speziell für den Einsatz in Blasformmaschinen entwickelt. Aufgrund der hohen Taktzeiten pro Stunde erreichen Standardstoßdämpfer schnell ihre Grenzen. Die Baureihe W-PET bietet konstante Leistung für bis zu 20 Mio. Hüben in erprobten Anwendungen wie z.B.:

- Herstellung von Kunststoff-Behältern
- Blasformmaschinen
- Spritzgießmaschinen
- Produktion von Kunststoff-Flaschen
- Anwendungen mit hoher Geschwindigkeit und Taktrate für außergewöhnliche Haltbarkeit und Leistung

Weforma PET shock absorbers are designed for use in blow molding machines. Due to high cycle times standard shock absorbers quickly fail. Series W-PET provides constant performance for up to 20 million cycles in approved applications such as:

- P.E.T. container manufacturers
- Blow molding machines
- Injection molding machines
- Plastic bottle manufacturers
- High-speed, repetitious applications requiring exceptional durability and performance

Les amortisseurs PET Weforma ont été élaborés spécialement pour une utilisation sur les souffleuses. En raison des cadences élevées, les amortisseurs classiques atteignent rapidement leurs limites. La série W-PET offre des performances constantes jusqu'à 20 millions de courses dans des utilisations éprouvées telles que:

- La production de conteneurs en plastique
- Les souffleuses
- Les machines de moulage par injection
- La production de bouteilles en plastique
- Les utilisations à grande vitesse et à des rythmes élevés pour une durée de vie et une performance exceptionnelles

Gli ammortizzatori Weforma PET sono stati ideati per l'impiego in macchine di stampaggio per soffiaggio. A causa degli elevati cicli ora, gli ammortizzatori standard raggiungono rapidamente i loro limiti. La serie W-PET fornisce una prestazione costante fino a 20 milioni di cicli in applicazioni collaudate, quali:

- Produzione di contenitori in plastica
- Macchine di stampaggio per soffiaggio
- Macchine di stampaggio a iniezione
- Produzione di bottiglie di plastica
- Applicazioni con alta velocità e cadenza per una durata e prestazioni eccezionali

Los amortiguadores PET de Weforma han sido desarrollados especialmente para su uso en moldeadoras-sopladoras.

Los amortiguadores estándar llegan rápidamente a sus límites debido al elevado número de ciclos por hora. La serie W-PET presta un servicio constante para hasta unos 20 millones de carreras en aplicaciones prácticas como estas:

- Producción de envases de plástico
- Moldeadoras-sopladoras
- Máquinas para moldear por inyección
- Producción de botellas de plástico
- Aplicaciones a velocidad y cadencia elevadas para una duración y un rendimiento extraordinarios

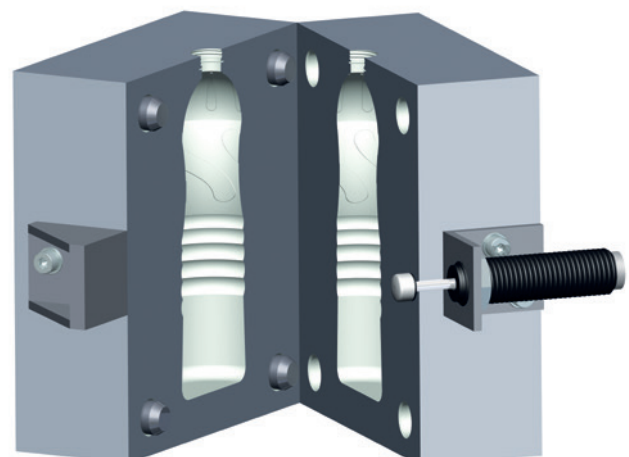

W-PET 0,25-1110

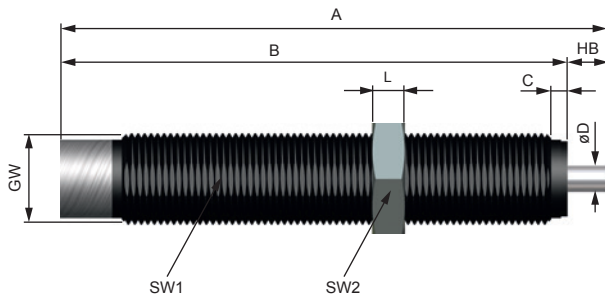

W-PET 0,5x13-XXXX

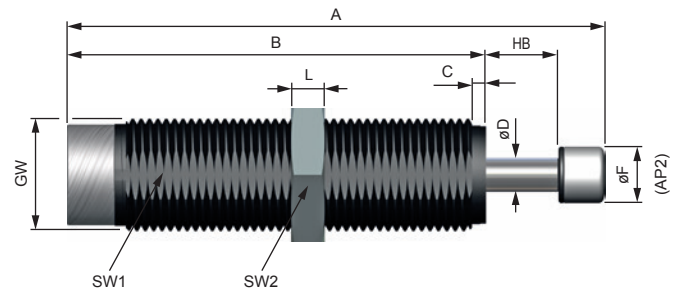

ABMESSUNGEN - DIMENSIONS - DIMENSIONI - DIMENSIONES

	Hub - Stroke Course - Corsa Carrera	Energieaufnahme - Energy absorption Energie d'absorption - Assorbimento d'energia Absorción de energía	GW	A	B	C	øD	øF (AP2)	L	SW1	SW2
	mm	Nm/Hub (max.)		mm	mm	mm	mm	mm	mm	mm	mm
W-PET 0,25-1110	6,4	25	M 14 x 1	84,4	78	2,5	4	-	5	17	13
W-PET 0,5x13-330	13	50	M 20 x 1,5	97	75	2,5	6	10	6	18	24
W-PET 0,5x13-380	13	50	M 20 x 1,5	110	88	2,5	6	10	6	18	24
W-PET 0,5x13-1730	13	50	M 20 x 1,5	97	75	2,5	6	10	6	18	24

Zubehör Seite 95 • Accessories Pages 95 • Accessoires Page 95 • Accessori Pagina 95 • Accesorios Página 95

Typ 1 W-PET 1,0-XXXX

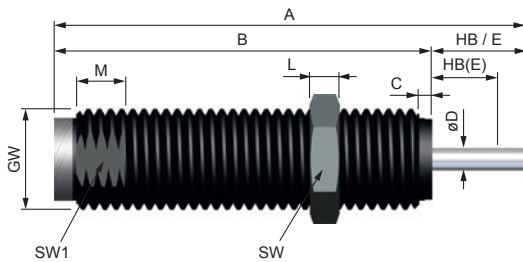

Typ 2 W-PET 1,0-XXXX

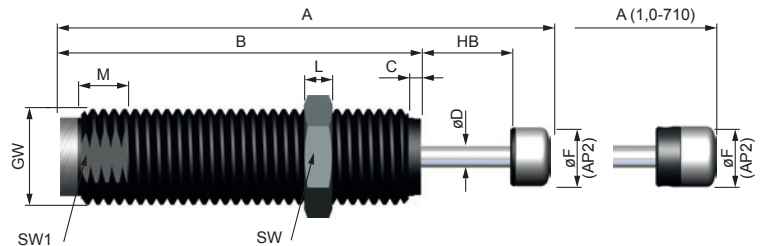

ABMESSUNGEN - DIMENSIONS - DIMENSIONI - DIMENSIONES

Typ Type Tipo	Hub - Stroke Course - Corsa Carrera	Energieaufnahme - Energy absorption Energie d'absorption - Assorbimento d'energia Absorción de energía	GW	A	B	C	øD	E	HB(E)	øF (AP2)	SW	SW1	M	L
	mm	Nm/Hub (max.)		mm	mm	mm	mm	mm	mm	mm	mm	mm	mm	mm
W-PET 1,0-230	1	19	M 27 x 3	121	102	3,5	6	-	-	-	-	23	13	-
W-PET 1,0-240	1	25	M 27 x 3	127	102	3,5	6	-	-	-	-	23	13	-
W-PET 1,0-920	1	19	M 27 x 3	121	102	3,5	6	-	-	-	-	23	13	-
W-PET 1,0-1240	1	25	M 27 x 3	127	102	3,5	6	-	-	-	-	23	13	-
W-PET 1,0-1310	1	25	M 27 x 3	127	102	3,5	6	-	-	-	30	23	13	8
W-PET 1,0-1350	1	25	M 27 x 3	133	102	3,5	6	31	25	-	30	23	13	8
W-PET 1,0-1530	1	25	M 27 x 3	127	102	3,5	6	31	25	-	30	23	13	8
W-PET 1,0-140	2	25	M 27 x 3	139	102	3,5	6	-	-	17	-	23	13	-
W-PET 1,0-260	2	25	M 25 x 1,5	139	102	3,5	6	-	-	17	-	23	13	-
W-PET 1,0-330	2	25	M 27 x 3	139	102	3,5	6	-	-	17	30	23	13	8
W-PET 1,0-710	2	25	M 27 x 3	144,5	102	3,5	6	-	-	17	-	23	13	-
W-PET 1,0-1710	2	25	M 27 x 3	139	102	3,5	6	-	-	17	30	23	13	8
W-PET 1,0-1720	2	25	M 27 x 3	139	102	3,5	6	-	-	17	30	23	13	8
W-PET 1,0-2270	2	19	M 25 x 1,5	133	102	3,5	6	-	-	17	-	-	13	-

Zubehör Seite 95 • Accessories Pages 95 • Accessoires Page 95 • Accessori Pagina 95 • Accesorios Página 95

Typ 1 W-PET 1,0-XXXX

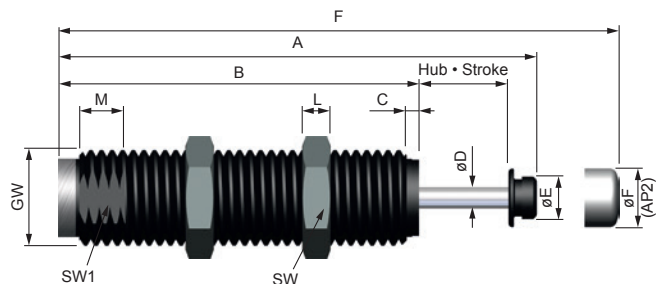

Typ 2 W-PET 1,0-XXXX

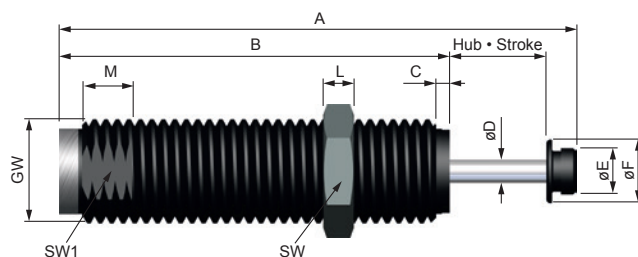

ABMESSUNGEN - DIMENSIONS - DIMENSIONI - DIMENSIONES

Typ	Hub - Stroke	Energieaufnahme - Energy absorption	GW	A	B	C	øD	øE	øF (AP2)	F	SW	L	SW1	M	
Type	Course - Corsa	Energie d'absorption - Assorbimento d'energia		mm	mm	mm	mm	mm	mm	mm	mm	mm	mm	mm	
Tipo	Carrera	Absorción de energía													
	mm	Nm/Hub (max.)		mm	mm	mm	mm	mm	mm	mm	mm	mm	mm	mm	
W-PET 1,0-120	1	25	100	M27x3	135	102	3,5	6	12	17	139	30	8	23	13
W-PET 1,0-1120	1	25	100	M27x3	135	102	3,5	6	12	17	139	30	8	23	13
W-PET 1,0-1360	2	25	100	M27x3	135	102	3,5	6	12	-	17	30	8	23	13

Zubehör Seite 95 • Accessories Pages 95 • Accessoires Page 95 • Accessori Pagina 95 • Accesorios Página 95

Typ 1 W-PET 1,0-XXXX

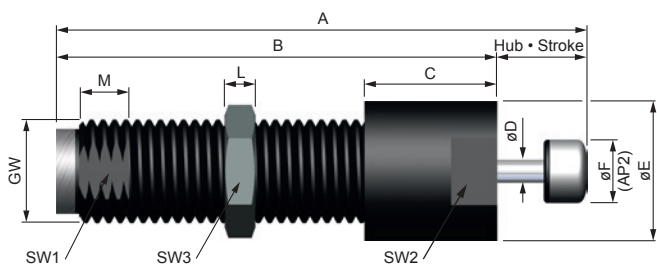

Typ 2 W-PET 1,0-XXXX

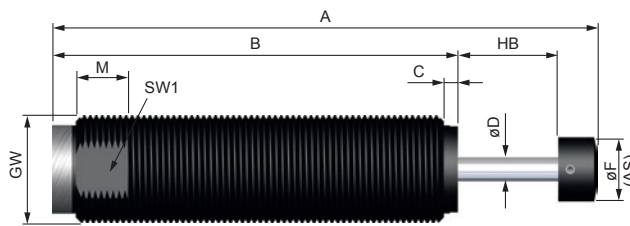

ABMESSUNGEN - DIMENSIONS - DIMENSIONI - DIMENSIONES

Typ	Hub - Stroke	Energieaufnahme - Energy absorption	GW	A	B	C	øD	øE	øF AP2	L	SW3	SW2	SW1	M	
Type	Course - Corsa	Energie d'absorption - Assorbimento d'energia		mm	mm	mm	mm	mm	mm	mm	mm	mm	mm	mm	
Tipo	Carrera	Absorción de energía													
	mm	Nm/Hub (max.)		mm	mm	mm	mm	mm	mm	mm	mm	mm	mm	mm	
W-PET 1,0-350	1	23,7	100	M27x3	139	115	34,6	6	36,5	17	8	30	32	23	13
W-PET 1,0-3240	2	25	100	M27x1,5	137	102	3,5	6	-	16	-	-	-	23	13
W-PET 1,0-3260	2	25	100	1-12 UNF	137	102	3,5	6	-	16	-	-	-	23	13
W-PET 1,0-3280	2	25	100	M25x1,5	137	102	3,5	6	-	16	-	-	-	23	13

Zubehör Seite 95 • Accessories Pages 95 • Accessoires Page 95 • Accessori Pagina 95 • Accesorios Página 95



W-PET 1,0-2240

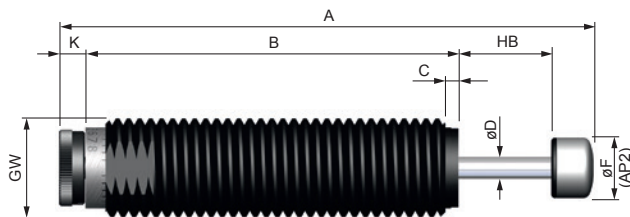

W-PET 1,0-870

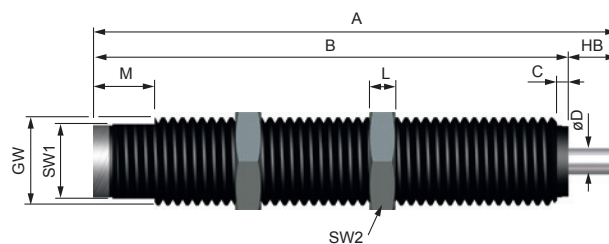

ABMESSUNGEN - DIMENSIONS - DIMENSIONI - DIMENSIONES

	Hub - Stroke Course - Corsa Carrera	Energieaufnahme - Energy absorption Energie d'absorption - Assorbimento d'energia Absorción de energía	GW	A	B	C	øD	øF (AP2)	K	SW1	M	L	SW2
	mm	Nm/Hub (max.)		mm	mm	mm	mm	mm	mm	mm	mm	mm	mm
W-PET 1,0-2240	25	100	M 27 x 3	147	102	3,5	6	17	8	-	-	-	-
W-PET 1,0-870	15	100	M 27 x 3	161	146	3,5	8	-	-	23	19	8	30

Zubehör Seite 95 • Accessories Pages 95 • Accessoires Page 95 • Accessori Pagina 95 • Accesorios Página 95

W-PET 1,0-1370

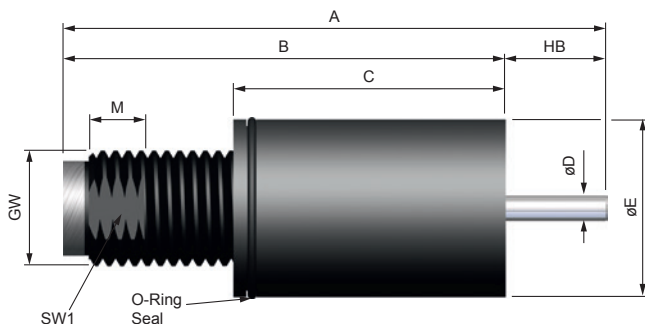

W-PET 1,0-940

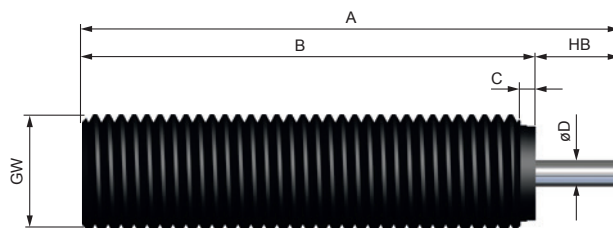

ABMESSUNGEN - DIMENSIONS - DIMENSIONI - DIMENSIONES

	Hub - Stroke Course - Corsa Carrera	Energieaufnahme - Energy absorption Energie d'absorption - Assorbimento d'energia Absorción de energía	GW	A	B	C	øD	øE	SW1	M
	mm	Nm/Hub (max.)		mm	mm	mm	mm	mm	mm	mm
W-PET 1,0x1370	23,9	100	M 27 x 3	127	103	63,6	6	41,5	23	13
W-PET 1,0-940	19	100	M 27 x 3	130	105	3,5	6	-	-	-

Zubehör Seite 95 • Accessories Pages 95 • Accessoires Page 95 • Accessori Pagina 95 • Accesorios Página 95

1 Kontermutter
1 Lock nut
1 Contre-écrou
1 Controdado
1 Contratuerca

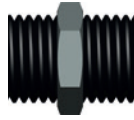

Anschlagkappe AP2
Stop cap AP2
Chapeau butoir AP2
Testina d'urto AP2
Cabeza de choque AP2

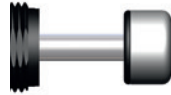

Anschlagkappe (Stahl / AS)
Stop cap (Steel / AS)
Chapeau butoir (Acier / AS)
Testina d'urto (Acciaio / AS) Cabeza de choque (Acero / AS)



Anschlagmutter
Stop limit nut
Bague de butée
Ghiera di arresto
Tuerca de tope

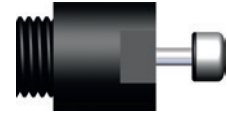

W-PET 0,25-1110	X			
W-PET 0,5x13-330	X	X		
W-PET 0,5x13-380	X	X		
W-PET 0,5x13-1730	X	X		
W-PET 1,0-1310	X			
W-PET 1,0-1350	X			
W-PET 1,0-1530	X			
W-PET 1,0-140		X		
W-PET 1,0-260		X		
W-PET 1,0-330	X	X		
W-PET 1,0-350	X	X		X
W-PET 1,0-710		X		
W-PET 1,0-1360	X		X	
W-PET 1,0-1710	X	X		
W-PET 1,0-1720	X	X		
W-PET 1,0-2270		X		
W-PET 1,0-3240			X	
W-PET 1,0-3260			X	
W-PET 1,0-3280			X	
W-PET 1,0-2240		X		
W-PET 1,0x1370				X

2 Kontermuttern
2 Lock nuts
2 Contre-écrous
2 Controdadi
2 Contratuercas

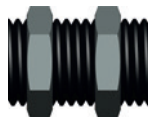

Anschlagkappe AP2 (lose mitgeliefert)
Stop cap AP2 (supplied loose)
Chapeau butoir AP2 (fourni séparément)
Testina d'urto AP2 (forniti sciolti)
Cabeza de choque AP2 (suministra suelto)



W-PET 1,0-120	X		X	
W-PET 1,0-1120	X		X	
W-PET 1,0-870	X			

Архангельск (8182)63-90-72
Астана (7172)727-132
Астрахань (8512)99-46-04
Барнаул (3852)73-04-60
Белгород (4722)40-23-64
Брянск (4832)59-03-52
Владивосток (423)249-28-31
Волгоград (844)278-03-48
Вологда (8172)26-41-59
Воронеж (473)204-51-73
Екатеринбург (343)384-55-89
Иваново (4932)77-34-06

Ижевск (3412)26-03-58
Иркутск (395)279-98-46
Казань (843)206-01-48
Калининград (4012)72-03-81
Калуга (4842)92-23-67
Кемерово (3842)65-04-62
Киров (8332)68-02-04
Краснодар (861)203-40-90
Красноярск (391)204-63-61
Курск (4712)77-13-04
Липецк (4742)52-20-81
Киргизия (996)312-96-26-47

Магнитогорск (3519)55-03-13
Москва (495)268-04-70
Мурманск (8152)59-64-93
Набережные Челны (8552)20-53-41
Нижний Новгород (831)429-08-12
Новокузнецк (3843)20-46-81
Новосибирск (383)227-86-73
Омск (3812)21-46-40
Орел (4862)44-53-42
Оренбург (3532)37-68-04
Пенза (8412)22-31-16
Россия (495)268-04-70

Пермь (342)205-81-47
Ростов-на-Дону (863)308-18-15
Рязань (4912)46-61-64
Самара (846)206-03-16
Санкт-Петербург (812)309-46-40
Саратов (845)249-38-78
Севастополь (8692)22-31-93
Симферополь (3652)67-13-56
Смоленск (4812)29-41-54
Сочи (862)225-72-31
Ставрополь (8652)20-65-13
Казахстан (772)734-952-31

Сургут (3462)77-98-35
Тверь (4822)63-31-35
Томск (3822)98-41-53
Тула (4872)74-02-29
Тюмень (3452)66-21-18
Ульяновск (8422)24-23-59
Уфа (347)229-48-12
Хабаровск (4212)92-98-04
Челябинск (351)202-03-61
Череповец (8202)49-02-64
Ярославль (4852)69-52-93